

CHILLFACTOR™
slushy maker
 INSTRUCTIONS

HOW TO MAKE THE BEST SLUSHIES!

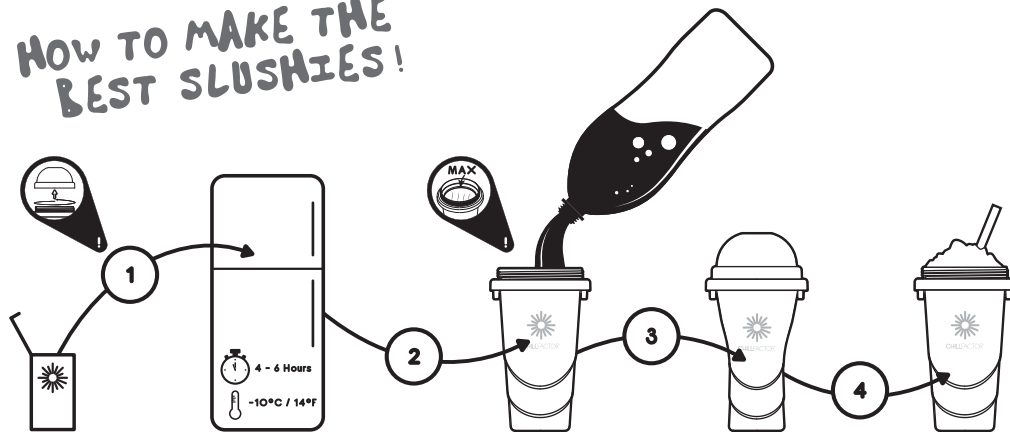

- 1 Remove the CHILLFACTOR™ JUMBO CUP from its packaging and follow the cleaning instructions. Then place upright in the freezer without the lid.
- 2 After 4 – 6 hours at below -10°C / 14°F ensure the walls of the CHILLFACTOR™ JUMBO CUP are frozen. If not, then try overnight. (You may need to lower the temperature of your freezer)
Once removed from the freezer, pour in your favorite chilled drink to the point where the cooling pack meets the plastic of the washer. (Approx 660ml)
- 3 Once you have poured your drink, screw the lid on and start squeezing the cup. In 2-3 minutes you will have a delicious slushy treat!
- 4 When you are happy with the consistency of your slushy, stop squeezing, insert your spoon straw and enjoy!
(When using the spoon, we suggest removing the lid of the CHILLFACTOR™ JUMBO CUP)

! CAUTION: Always check for leaks before freezing, avoid puncturing. The refrigerant liquid is non-toxic, however in the event a leak or puncture occurs, cease use and discard.

- Do not overfill.
- Only use drinks that are chilled. Hot drinks will not give you a slushy result (Ingredients higher than 60°C / 140°F could damage your product)
- Dairy products take longer to slush than juices or sodas. To achieve a better result with dairy, pour your ingredients into the cup and let it sit for 3 – 4 minutes in the freezer before you begin squeezing.

HOW TO CLEAN YOUR SLUSHY MAKER!

- 1 Unscrew and lift the lid.
- 2 Unscrew and lift the top collar.
- 3 Remove the washer.
- 4 Remove the cooling pack.
- 5 Remove the bottom collar.
- 6 The lid, top collar, bottom collar and washer are top-rack dishwasher safe. The silicone cup and the cooling pack are hand washable only.

CARE INSTRUCTIONS

- Don't pierce the cup or its cooling pack with any sharp object. Only use the plastic spoon straw to consume your slushy.
- For optimum performance and longevity, after using we recommend always storing the cooling pack of the Chill Factor product in the freezer unit of your refrigerator.
- Be sure to wash the CHILLFACTOR™ JUMBO CUP before every use.
- The lid, top collar, bottom collar and washer are top-rack dishwasher safe.
- The silicone cup and the cooling pack are hand washable only.
- This product is only suitable for exposure to temperatures in the range of -25°C to +60°C
- CAUTION! ONLY USE COLD OR WARM WATER TO CLEAN THE COOLING PACK.

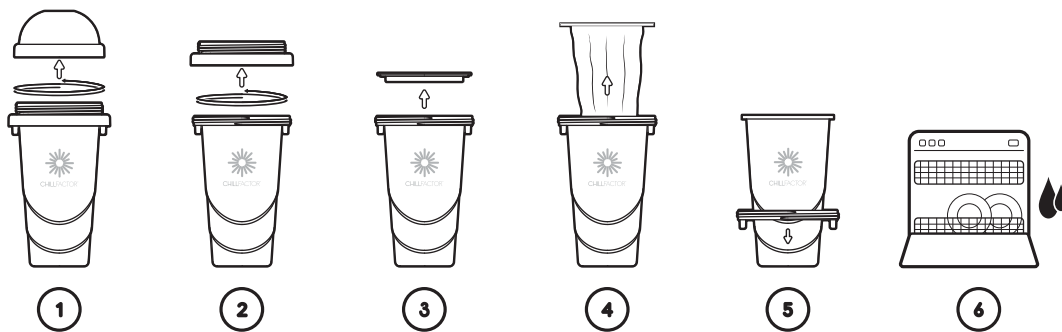

FUNTASTIC LIMITED.
 Level 2, Tower 2, Chadstone Place,
 1541 Dandenong Road,
 Chadstone, 3148, Australia

QUALITY GUARANTEE
 Funtastic Limited guarantees the quality of this Chill Factor™ Slushy Maker.
 If it doesn't meet your expectations call us on 1800 244 543 or email info@funtastic.com.au

Patent Protected:
 Chinese Patent ZL 2005 8 0042009.8
 AUS Patent 2005316204
 US Patent 7547792
 Various International Patents Pending over product and composition of materials in product.
 Made in China.



thechillfactor.com
 See me in action online.



WE MAKE COOL STUFF THAT MAKES STUFF COOL

| | | |
|------------|--------------|--------------------------|
| | Project Name | Slushy Maker - Jumbo Cup |
| | Item No. | CF001502 |
| | Packaging | Instruction |
| | Color | 1C |
| | Size | 228 x 128 mm |
| | Date | 15 Jan 2015 |
| Color Ref. | | |