

Instructions

POPPIN' DOTS FROZEN DOT MAKER

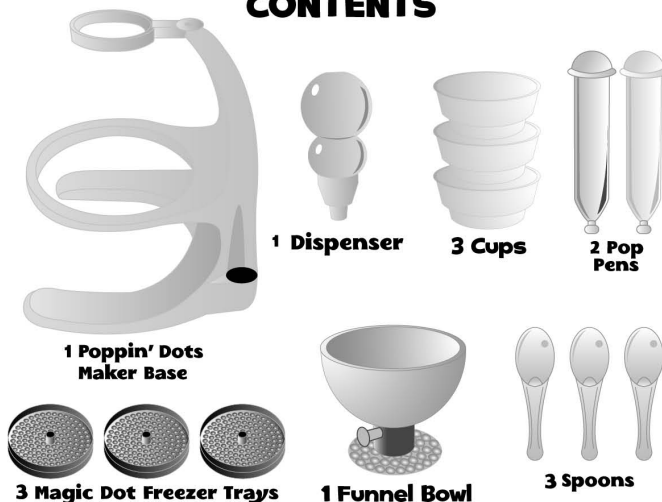

CONTENTS



Try These Delicious Poppin' Dots Recipes!

Mango Smoothie:
Mango Juice + Coconut Milk

Extreme Punch:
Fruit Punch + Pineapple Juice

Ginger Kicker:
Ginger Ale + Pineapple Juice + Lime Juice

Watermelon Cream:
Watermelon Juice + Coconut Milk

Top off your Poppin' Dots Frozen Dots with chocolate chips/chocolate or fruit sauce/sprinkles/fresh fruit/cream/ice cream – use your imagination!

MAKING FROZEN DOTS

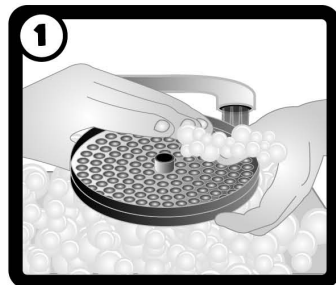

1

WASH BEFORE FIRST TIME USE!
Wash all parts with warm soapy water. Do **NOT** use Dishwasher.

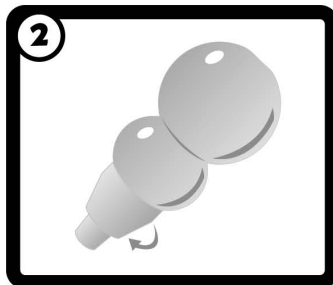

2

Unscrew bottom of dispenser. Fill dispenser with your favourite recipe.

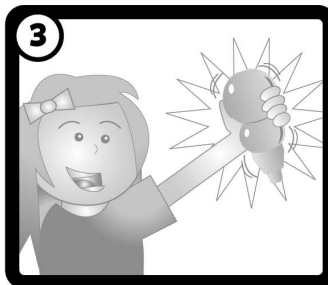

3

Replace the bottom of the dispenser.

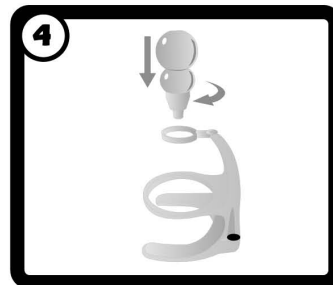

4

Place the dispenser into the ring of the base and turn to lock in place.

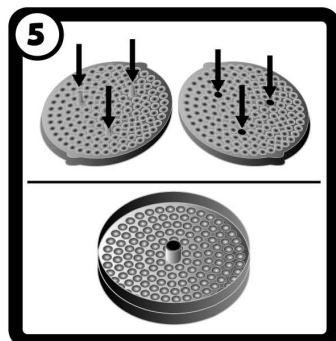

5

Important! Firmly lock tray top and bottom to avoid leaks.



6

Push the lock on the bowl to the Closed position to restrict any liquid from draining. Attach one of the trays with the bowl and place it on the stand.

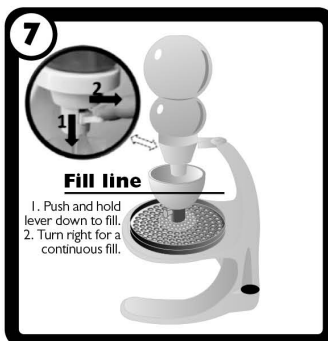

7

Press lever to fill bowl — Only up to fill line.

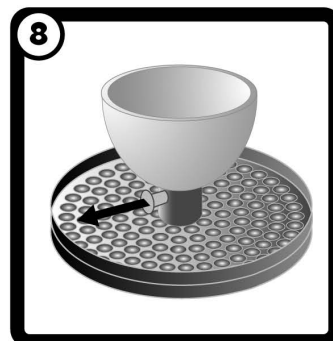

8

Fill dot tray — release the lock on the dispenser bowl to fill.



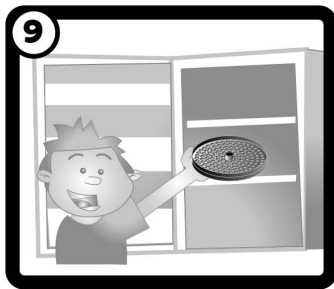

- When the bowl is empty and the dot tray is full, remove the bowl.
- Remove any standing liquid on the top of the tray with a towel.
- Place the tray on a flat surface in the freezer.
- Freezing time can take up to 2-3 hours. Freezing times will vary.

NOTE: Remember to close the lock on bowl before removing it (so it does not leak).



- Remove the tray from the freezer and run under water for 5-10 seconds.
- Bend the tray back and forth 1-2 times to break up the dots.
- Open the tray and pour the dots into a serving bowl.
- Congratulations! Your frozen dots are ready to eat!

TROUBLESHOOTING

Problem	Solution
Dots are frozen together	<ul style="list-style-type: none"> • Top and bottom trays must be tightly closed together. • After freezing bend the sealed frozen tray back and forth 1-2 times before opening. • Do not use juice with pulp. • Use the spoon to gently break apart any dots that are frozen together.
Dot Pens leak	<ul style="list-style-type: none"> • Bubble valve must be securely mounted to pen.
Dot Pens do not fill Dot Tray	<ul style="list-style-type: none"> • Only fill using center hole of Dot Tray. • After each PRESS of Bubble Valve, pull tip of pen out of Tray to allow air to enter.

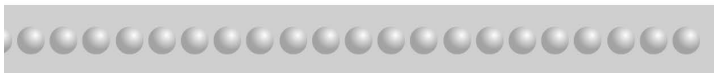

POP PENS MAY ALSO BE USED TO FILL DOT TRAYS!

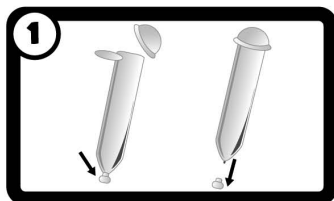

- Keep the nozzle cap in place and fill your pen with the recipe of your choice.
- Secure bubble top in place.

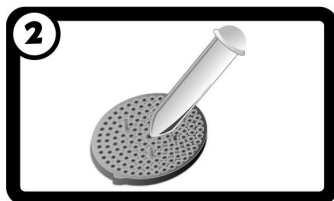

- Fill freezer trays by placing nozzle into center hole and press down on the bubble top.
- Pull nozzle out of hole when releasing bubble cap to let air in.
- Repeat these steps to fill entire tray.

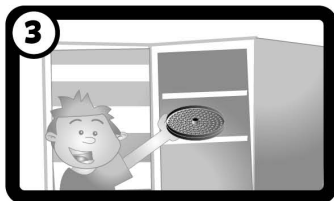

- When the dot tray is full remove any standing liquid on the top of the tray with a towel.
- Place the tray on a flat surface in the freezer.
- Freezing time can take up to 2-3 hours. Freezing times will vary.

NOTE: Remember to close the lock on bowl before removing it (so it does not leak).

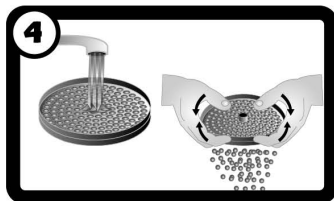

- Remove the tray from the freezer and run under water for 5-10 seconds.
- Bend the tray back and forth 1-2 times to break up the dots.
- Open the tray and pour the dots into a serving bowl.
- Congratulations! Your frozen dots are ready to eat!

WARNING! CHOKING HAZARD.

Not suitable for children under 36 months. Choking hazard (small parts). Please remove all packaging attachments before giving this product to a child. Please use discretion if making purchases for children younger than the age recommended on this package. Product specifications, colour and contents may vary from those illustrated. **IMPORTANT:** Please retain packaging / instructions and purchase details for future reference as they contain important information. **WARNING!** To be used under the direct supervision of an adult.



Item: **CHILLFACTOR POPPIN' DOTS FROZEN DOT MAKER**
Item Number: 92489
Age Grader: 3 years plus

RECYCLING OUR PRODUCTS

All our product and packaging is designed with easy and safe recycling in mind. For information on the **National Recycling Strategy** and the recycling logo on this pack or product please visit - www.Recycle-More.co.uk - where you will find the answers to your UK recycling questions.



Imported by:
Character Options Ltd.,
Lees Brook Mill, Lees Road,
Lees, Oldham OL4 5JL, UK
Customer Service Department
Tel No: **0161 633 9808**
Made in China

www.character-online.co.uk

PROXY A/S
GOTHERSGADE 14, 3RD FLOOR DK-1123
COPENHAGEN K, DENMARK
www.proxyas.com

Wash Product Thoroughly Before Use

In the interest of better quality and value, we are constantly improving and updating our products. Consequently, pictures on this package may sometimes differ from the model enclosed.

The end results from this toy are not an exact representation of Dippin' Dots, LLC. Dippin' Dots, LLC is a trademark of Dippin' Dots, LLC. The design and shape of the Dippin' Dots, LLC Frozen Dot Maker are owned by Big Time Toys, LLC. Manufactured By: © 2020 Big Time Toys, LLC. 2823 Dogwood Place Nashville, TN 37204. All Rights Reserved.

